



Magellan[®] 1000i

Omni-Directional Imaging Scanner



クイック・リファレンス ・ **Quick Reference Guide**
Guida Rápida ・ **Guide de Référence Rapide**
快速参考 ・ **Guía de Referencia Rápida**
Schnellanleitung ・ **Referência Rápida**

PSC Inc

959 Terry Street

Eugene, Oregon 97402

Telephone: (541) 683-5700

Fax: (541) 345-7140

An Unpublished Work - All rights reserved. No part of the contents of this documentation or the procedures described therein may be reproduced or transmitted in any form or by any means without prior written permission of PSC Inc. or its wholly owned subsidiaries ("PSC"). Owners of PSC products are hereby granted a non-exclusive, revocable license to reproduce and transmit this documentation for the purchaser's own internal business purposes. Purchaser shall not remove or alter any proprietary notices, including copyright notices, contained in this documentation and shall ensure that all notices appear on any reproductions of the documentation.

Should future revisions of this manual be published, you can acquire printed versions by contacting your PSC representative. Electronic versions may either be downloadable from the PSC website (www.psc.com) or provided on appropriate media. If you visit our website and would like to make comments or suggestions about this or other PSC publications, please let us know via the "Contact PSC" page.

Disclaimer

PSC has taken reasonable measures to provide information in this manual that is complete and accurate, however, PSC reserves the right to change any specification at any time without prior notice.

PSC is a registered trademark of PSC Inc. The PSC logo is a trademark of PSC. All other trademarks and trade names referred to herein are property of their respective owners.

This product may be covered by one or more of the following patents: 4603262 • 4639606 • 4652750 • 4672215 • 4699447

• 4709369 • 4749879 • 4786798 • 4792666 • 4794240 • 4798943 • 4799164 • 4820911 • 4845349 • 4861972 • 4861973 • 4866257 • 4868836 • 4879456 • 4939355 • 4939356 • 4943127 • 4963719 • 4971176 • 4971177 • 4991692 • 5001406 • 5015831 • 5019697 • 5019698 • 5086879 • 5115120 • 5144118 • 5146463 • 5179270 • 5198649 • 5200597 • 5202784 • 5208449 • 5210397 • 5212371 • 5212372 • 5214270 • 5229590 • 5231293 • 5232185 • 5233169 • 5235168 • 5237161 • 5237162 • 5239165 • 5247161 • 5256864 • 5258604 • 5258699 • 5260554 • 5274219 • 5296689 • 5298728 • 5311000 • 5327451 • 5329103 • 5330370 • 5347113 • 5347121 • 5371361 • 5382783 • 5386105 • 5389917 • 5410108 • 5420410 • 5422472 • 5426507 • 5438187 • 5440110 • 5440111 • 5446271 • 5446749 • 5448050 • 5463211 • 5475206 • 5475207 • 5479011 • 5481098 • 5491328 • 5493108 • 5504350 • 5508505 • 5512740 • 5541397 • 5552593 • 5557095 • 5563402 • 5565668 • 5576531 • 5581707 • 5594231 • 5594441 • 5598070 • 5602376 • 5608201 • 5608399 • 5612529 • 5629510 • 5635699 • 5641958 • 5646391 • 5661435 • 5664231 • 5666045 • 5671374 • 5675138 • 5682028 • 5686716 • 5696370 • 5703347 • 5705802 • 5714750 • 5717194 • 5723852 • 5750976 • 5767502 • 5770847 • 5786581 • 5786585 • 5787103 • 5789732 • 5796222 • 5804809 • 5814803 • 5814804 • 5821721 • 5822343 • 5825009 • 5834708 • 5834750 • 5837983 • 5837988 • 5852286 • 5864129 • 5869827 • 5874722 • 5883370 • 5905249 • 5907147 • 5923023 • 5925868 • 5929421 • 5945670 • 5959284 • 5962838 • 5979769 • 6000619 • 6006991 • 6012639 • 6016135 • 6024284 • 6041374 • 6042012 • 6045044 • 6047889 • 6047894 • 6056198 • 6065676 • 6069696 • 6073849 • 6073851 • 6094288 • 6112993 • 6129279 • 6129282 • 6134039 • 6142376 • 6152368 • 6152372 • 6155488 • 6166375 • 6169614 • 6173894 • 6176429 • 6188500 • 6189784 • 6213397 • 6223986 • 6230975 • 6230976 • 6237852 • 6244510 • 6259545 • 6260763 • 6266175 • 6273336 • 6276605 • 6279829 • 6290134 • 6290135 • 6293467 • 6303927 • 6311895 • 6318634 • 6328216 • 6332576 • 6332577 • 6343741 • 6454168 • 6478224 • 6,568,598 • 6,578,765 • 6705527 • 6,974,084 • AU703547 • D312631 • D313590 • D320011 • D320012 • D323492 • D330707 • D330708 • D349109 • D350127 • D350735 • D351149 • D351150 • D352936 • D352937 • D352938 • D352939 • D358588 • D361565 • D372234 • D374630 • D374869 • D375493 • D376357 • D377345 • D377346 • D377347 • D377348 • D388075 • D446524 • EP0256296 • EP0260155 • EP0260156 • EP0295936 • EP0325469 • EP0349770 • EP0368254 • EP0442215 • EP0498366 • EP0531645 • EP0663643 • EP0698251 • GB2252333 • GB2284086 • GB2301691 • GB2304954 • GB2307093 • GB2308267 • GB2308678 • GB2319103 • GB2333163 • GB2343079 • GB2344486 • GB2345568 • GB2354340 • ISR107546 • ISR118507 • ISR118508 • JP1962823 • JP1971216 • JP2513442 • JP2732459 • JP2829331 • JP2953593 • JP2964278 • MEX185552 • MEX187245 • RE37166 • Other Patents Pending

Table of Contents

English	1
Français	5
Deutsch	9
Italiano	13
Español	17
Portugues	21
Chinese	25
Japanese	29

PSC INC. MAGELLAN® END USER LICENSE AGREEMENT

Notice to End User: The PSC Product you have acquired contains embedded Software, which is integral to the product's operation. This Software is being provided to you under license, subject to the terms and conditions of this Agreement. If you use the PSC Product, you will be deemed to have accepted the terms and conditions of this Agreement. If you do not intend to be bound to the terms of this Agreement, PSC is not willing to license the Software to you, you may not use the PSC Product or the Software, and you must contact the party from whom you acquired the PSC Product for instructions.

This End User Software License Agreement ("Agreement") is a legally binding agreement governing the licensing of the Software and Documentation by PSC Inc. and its wholly owned subsidiaries and affiliates ("PSC") to the entity or person who has purchased or otherwise acquired a PSC Product ("End User"). For purposes of this Agreement, any software that is associated with a separate end-user license agreement is licensed to you under the terms of that license agreement. PSC and End User hereby agree as follows:

1. Definitions.

- 1.1 "Documentation" means materials such as user's guides, program reference guides, quick reference guides, manuals, or similar materials associated with or related to the PSC Product, whether in printed, "online", or other form.
- 1.2 "Proprietary Information" means: (a) source code, object code, software, documentation, and any related internal design, system design, data base design, algorithms, technology, technical data or information, implementation techniques, and trade secrets related to the Software, (b) any other trade secrets marked appropriately or identified as proprietary or confidential, and (c) any information that End User, under the circumstances, should recognize as confidential. Proprietary Information does not include any information that the receiving party can establish was (1) in the public domain, (2) already in the receiving party's possession or rightfully known prior to receipt, (3) rightfully learned from a third party not in violation of any other's proprietary rights, or (4) independently developed without access to Proprietary Information.
- 1.3 "PSC Product" means the PSC Magellan® 9500 series, Magellan® 8500 series, Magellan® 8200 series, Magellan® 8100 series, and/or Magellan SL® series scanner and/or scanner/scale product, including all embedded Software in and all Documentation related to such product, which has been purchased or otherwise acquired by End User, whether obtained directly or indirectly from PSC.
- 1.4 "Software" means any software or computer programs of PSC or its third party licensors in machine readable form which is embedded in the PSC Product, whether obtained directly or indirectly from PSC, including any replacement, update, upgrade, enhancement or modification.

2. Scope Of License Granted.

- 2.1 PSC grants to End User a non-exclusive, non-transferable, perpetual license to use the Software, solely on the PSC Product in which it is embedded ("designated PSC Product"), in machine-readable form only, solely for End User's internal business purposes. This Agreement does not convey ownership of the Software to End User. Title to the Software shall be and remain with PSC or the third party from whom PSC has obtained a licensed right. As used in this Agreement, the term "purchase" or its equivalents when applied to the Software shall mean "acquire under license." End User is not entitled to receipt or use of the source code to any Software.
- 2.2 End User shall not copy, modify, decompile, disassemble, reverse engineer, or otherwise reproduce or remanufacture the Software, whether modified or unmodified, nor sell, assign, sublicense, distribute, lend, rent, give, or otherwise transfer the Software to any other person or organization, for purposes other than as expressly provided in this Agreement, without PSC's prior written consent.

3. Transfers, Support.

- 3.1 Any copying, installing, reproduction, remanufacture, reverse engineering, electronic transfer, or other use of the Software on other than the designated PSC Product will be a

material breach of this Agreement. However, PSC may elect not to terminate this Agreement or the granted licenses, but instead may elect to notify End User that End User is deemed to have ordered and accepted a license for each breaching use. End User shall pay PSC the applicable list price for such licenses as of the date of such breach.

- 3.2 End User shall not sell, assign, sublicense, distribute, lend, rent, give, or otherwise transfer the PSC Product to any third party unless such third party agrees with PSC in writing to be bound by the terms and conditions of this Agreement. Any such transfer of the PSC Product absent such agreement shall be null and void.
- 3.3 End User may obtain support for Software from PSC at PSC's standard support fees and under PSC's standard support terms and conditions in effect at the time the support is requested.

4. Intellectual Property.

End User acknowledges that the Software constitutes valuable trade secrets of PSC or PSC's third party licensors and that the Software is protected by intellectual property laws and treaties. The license set forth in this Agreement does not transfer to End User any ownership of PSC's or its third party licensors' copyrights, patents, trademarks, service marks, trade secrets, or other intellectual property rights and End User shall have no right to commence any legal actions to obtain such rights. End User shall not remove, modify, or take any other action that would obscure any copyright, trademark, patent marking, or other intellectual property notices contained in or on the PSC Product.

5. Proprietary Information.

- 5.1 End User acknowledges that Proprietary Information is the confidential, proprietary, and trade secret property of PSC and PSC's third party licensors and End User acquires no right or interest in any Proprietary Information.
- 5.2 End User shall not disclose, provide, or otherwise make available the Proprietary Information of PSC or its third party licensors to any person other than End User's authorized employees or agents who are under confidentiality agreement, and End User shall not use the Proprietary Information other than in conjunction with use of the PSC Product exclusively for End User's internal business purposes. End User shall take steps to protect the Proprietary Information no less securely than if it were End User's own intellectual property.
- 5.3 The provisions of this Proprietary Information Section shall survive and continue for five (5) years after the termination of this Agreement.

6. Limited Warranty.

- 6.1 PSC warrants that, under normal use and operation, the PSC Product will conform substantially to the applicable Documentation for the period specified in the Documentation. During this period, for all reproducible nonconformities for which PSC has been given written notice, PSC will use commercially reasonable efforts to remedy nonconformities verified by PSC. End User agrees to supply PSC with all reasonably requested information and assistance necessary to help PSC in remedying such nonconformities. For all defects reported to PSC within the warranty period, PSC's liability is limited to providing End User with one copy of corrections or responding to End User's problem reports according to PSC's standard assistance practices. PSC does not warrant that the product will meet End User's requirements or that use of the product will be uninterrupted or error free, or that PSC's remedial efforts will correct any nonconformance. This limited warranty does not cover any product that have been subjected to damage or abuse, whether intentionally, accidentally, or by neglect, or to unauthorized repair or unauthorized installation, and shall be void if End User modifies the product, uses the product in any manner other than as established in the Documentation, or if End User breaches any of the provisions of this Agreement.
- 6.2 EXCEPT AS PROVIDED IN THIS AGREEMENT, THE PSC PRODUCT IS PROVIDED "AS IS" AND PSC MAKES NO WARRANTIES OF ANY KIND, EXPRESS OR IMPLIED, WRITTEN OR ORAL, WITH RESPECT TO THE PRODUCT, AND SPECIFICALLY DISCLAIMS THE IMPLIED WARRANTIES OF MERCHANTABILITY AND FITNESS FOR A PARTICULAR PURPOSE.

7. Infringement.

- 7.1 PSC will defend End User against any claim in a lawsuit that the PSC Product furnished hereunder infringe a United States patent or copyright of a third party and PSC will pay any damages finally awarded against End User by a court of competent jurisdiction that

are attributable to such claim or will pay End User's part of any settlement that is attributable to such claim, provided, that 1) End User notifies PSC promptly in writing of the claim, 2) PSC controls the defense or settlement of the claim, and 3) End User cooperates fully with PSC in such defense or settlement. All notices of a claim should be sent to PSC Inc., Legal Department, 111 SW Fifth Ave. Suite 4100, Portland, OR 97204-3644.

- 7.2 In the defense or settlement of any such claim, PSC may, at its option, 1) procure for End User the right to continue using the PSC Product, 2) modify the PSC Product so that it becomes non-infringing, 3) replace the PSC Product with an equivalent product not subject to such claim, or 4) provide End User an opportunity to return the PSC Product and receive a refund of the purchase price paid, less a reasonable allowance for use.
- 7.3 PSC shall have no liability to End User for claims of infringement based upon 1) the use of any PSC Product in combination with any product which PSC has not either furnished or authorized for use with such PSC Product 2) the use of any PSC Product designed, manufactured, or modified to the specifications of End User, or 3) End User's modification of the PSC Product without written authorization from PSC.
- 7.4 THE FOREGOING STATES PSC'S COMPLETE AND ENTIRE OBLIGATION CONCERNING CLAIMS OF PATENT, COPYRIGHT, OR OTHER INTELLECTUAL PROPERTY INFRINGEMENT, CANCELS AND SUPERCEDES ANY PRIOR AGREEMENTS, WHETHER ORAL OR WRITTEN, BETWEEN THE PARTIES CONCERNING SUCH CLAIMS, AND WILL NOT BE MODIFIED OR AMENDED BY ANY PAST, CONTEMPORANEOUS, OR FUTURE AGREEMENTS OR DEALINGS BETWEEN THE PARTIES, WHETHER ORAL OR WRITTEN, EXCEPT AS SET FORTH IN A FUTURE WRITING SIGNED BY BOTH PARTIES.

8. Limitation Of Liability.

EXCEPT AS PROVIDED IN SECTION 7, PSC SHALL NOT BE LIABLE FOR ANY CLAIMS AGAINST END USER BY ANY OTHER PARTY. IN NO EVENT SHALL PSC'S LIABILITY FOR DAMAGES, IF ANY, WHETHER BASED UPON CONTRACT, TORT (INCLUDING NEGLIGENCE), PRODUCT LIABILITY, STRICT LIABILITY, WARRANTY, OR ANY OTHER BASIS, EXCEED THE PRICE OR FEE PAID BY END USER FOR THE PSC PRODUCT. UNDER NO CIRCUMSTANCES SHALL PSC BE LIABLE TO END USER OR ANY THIRD PARTY FOR LOST PROFITS, LOST DATA, INTERRUPTION OF BUSINESS OR SERVICE, OR FOR ANY OTHER SPECIAL, CONSEQUENTIAL, CONTINGENT, INDIRECT, INCIDENTAL, PUNITIVE, EXEMPLARY, OR OTHER SIMILAR DAMAGES, EVEN IF PSC HAS BEEN ADVISED OF THE POSSIBILITY OF SUCH DAMAGES.

9. Government Restricted Rights; International Use.

- 9.1 Use, duplication, or disclosure of the Software by the U.S. Government is subject to the restrictions for computer software developed at private expense as set forth in the U.S. Federal Acquisition Regulations at FAR 52.227-14(g), or 52.227-19 or in the Rights in Technical Data and Computer Software clause at DFARS 252.227-7013(c)(1)(ii), whichever is applicable.
- 9.2 If End User is using the PSC Product outside of the United States, End User must comply with the applicable local laws of the country in which the PSC Product is used, with U.S. export control laws, and with the English language version of this Agreement. The provisions of the "United Nations Convention on International Sale of Goods" shall not apply to this Agreement.

10. Termination.

- 10.1 Either party may terminate this Agreement or any license granted under this Agreement at any time upon written notice if the other party breaches any provision of this Agreement.
- 10.2 Upon termination of this Agreement, End User immediately shall cease using any non-embedded software and shall return to PSC or destroy all non-embedded software covered by this Agreement, and shall furnish PSC with a certificate of compliance with this provision signed by an officer or authorized representative of End User. For embedded software, End User agrees to sign a waiver prepared by PSC concerning further use of the embedded Software. End User's resumed or continued use of the embedded Software after termination shall constitute End User's agreement to be bound by the terms and conditions of this Agreement for such use.

11. General Provisions.

- 11.1 Entire Agreement; Amendment. This document contains the entire agreement between

the parties relating to the licensing of the Software and supersedes all prior or contemporaneous agreements, written or oral, between the parties concerning the licensing of the Software. This Agreement may not be changed, amended, or modified except by written document signed by PSC.

- 11.2 Notice. All notices required or authorized under this Agreement shall be given in writing, and shall be effective when received, with evidence of receipt. Notices to PSC shall be sent to the attention of Contract Administration, PSC Scanning Inc., 959 Terry Street, Eugene, OR 97402, or such other address as may be specified by PSC in writing.
- 11.3 Waiver. A party's failure to enforce any of the terms and conditions of this Agreement shall not prevent the party's later enforcement of such terms and conditions.
- 11.4 Governing Law; Venue: This Agreement and the rights of the parties hereunder shall be governed by and construed in accordance with the laws of the State of Oregon U.S.A, without regard to the rules governing conflicts of law. The state or federal courts of the State of Oregon located in either Multnomah or Lane counties shall have exclusive jurisdiction over all matters regarding this Agreement, except that PSC shall have the right, at its absolute discretion, to initiate proceedings in the courts of any other state, country, or territory in which End User resides, or in which any of End User's assets are located.
- 11.5 Attorneys' Fees. In the event an action is brought to enforce the terms and conditions of this Agreement, the prevailing party shall be entitled to reasonable attorneys' fees, both at trial and on appeal.

- END -

Quick Reference

This guide is provided to help get your installation up-and-running quickly and efficiently. For more details, including programming information, reference the Product Reference Guide (PRG), which is available for viewing and download from the PSC website listed on the back cover of this manual.

Installation

Route the interface cable from the terminal or host. Plug the AC adapter (if one is used) into a wall outlet and the interface (I/F) cable, then route and attach the I/F cable to the scanner. Verify operation by presenting known-good bar codes to the scanner. The unit should beep¹ and/or flash its good read LED and send the bar code data to the host or terminal. If not, refer to the Troubleshooting section of this guide.

Scanner installation is complete.

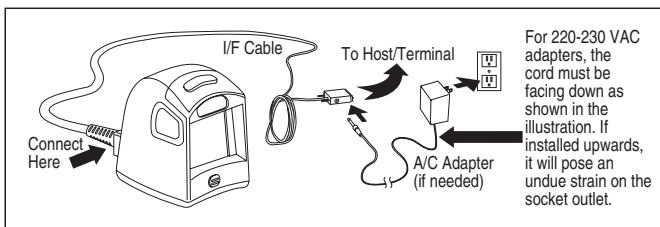

1. Beeper and LED behavior is selectable and may have been disabled by a previous user.

Optional Stand

An optional stand is available for the scanner which can be permanently attached to a wall or countertop. After locating the stand in an optimal position, the scanner (along with the stand) can be detached for portable use by lifting the entire unit as shown below.

Power Supply

Some models require¹ either a Listed Class 2 or Listed LPS power source which supplies power directly to the unit.

How to Scan

Bar codes can be presented to the scanner while it is resting on the counter or in the optional stand, or the scanner/mount can be lifted and held as shown.

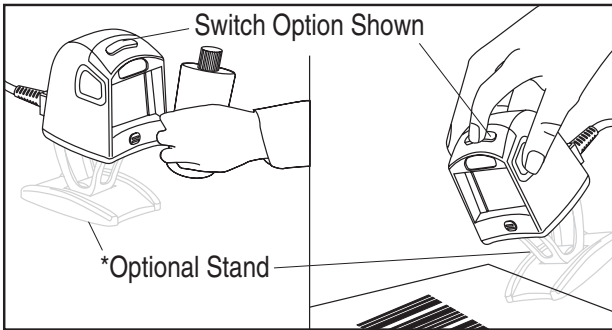

1. Power Off the Terminal (POT) units do not require a power supply.

Targeted Scanning Mode

In order to read a bar code (switch option only)...

- press and hold the switch. An aiming pattern will appear.
- with the aiming pattern fairly centered over the bar code to be read, release the switch to read the label.



NOTE

The scanner will not read bar codes while the switch is pressed.

Targeted Scanning Mode will read bar codes in any orientation.

The scanner will return to full pattern Omni Mode after a configurable time has elapsed.

Troubleshooting

If the scanner is not operating properly, the following checks should be performed:

1. If the scanner uses an external power supply and the external power supply has failed, the scanner will not operate. Exchange the power supply with a known good power supply and retest operation.

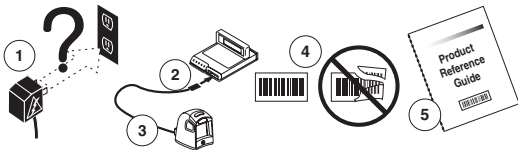

2. Verify the interface cable is securely attached to the host. Consult your technical support personnel or refer to your host system manual to verify the proper connection for the scanner.

3. Verify that the interface cable is securely attached to the scanner.
4. Check that the bar codes are of sufficient quality to be recognized by the scanner. Wrinkled, smudged, or torn labels can cause the scanner to not read at all. Scan known-good labels of an active symbology¹ to check the scanner's read operation.
5. Ensure that the scanner's interface type is compatible with the host terminal by consulting your POS system manual and/or the Product Reference Guide.

If the scanner still does not function properly, contact your local supplier or PSC Customer Support Services.

Compliance Statement

This device complies with Part 15 rules. Operation is subject to the following conditions:

1. This device may not cause harmful interference; and
2. This device must accept any interference received, including interference that may cause undesired operation.

This Class A digital apparatus complies with Canadian ICES -003.

Cet appareil numérique de la classe A est conforme à la norme NMB-003 du Canada.

LED Class

CLASS 1 LED PRODUCT	APPARECCHIO LED CLASSE 1
LED KLASSE 1	APPAREIL A LED DE CLASSE 1
	EN60825-1

-
1. Reading of the various bar code symbologies can be independently enabled or disabled in the scanner.

Guide de Référence Rapide

Ce guide est fourni afin de vous aider à installer rapidement et efficacement votre lecteur de codes à barres. Pour plus de détails concernant les informations sur la programmation, consultez le Guide de Référence du Produit qui est disponible soit pour lecture soit pour téléchargement à partir du site Internet PSC indiqué au dos de ce manuel.

Installation

Acheminez le câble d'interface à partir du terminal ou de l'ordinateur hôte. Branchez l'adaptateur CA (courant alternatif) (s'il est nécessaire d'en utiliser un) à une prise du mur et le câble d'interface (I/F), ensuite acheminez et connectez le câble I/F au scanner. Vérifiez l'opération en présentant au scanner des codes à barres corrects. L'unité devrait émettre un bip¹ sonore et/ou faire clignoter la diode pour confirmer que la saisie est correcte et envoyez les données du codes à barres à un ordinateur hôte ou au terminal. Si ce n'est pas le cas, consultez la section Diagnostic de Pannes de ce guide.

L'installation du scanner est terminée.

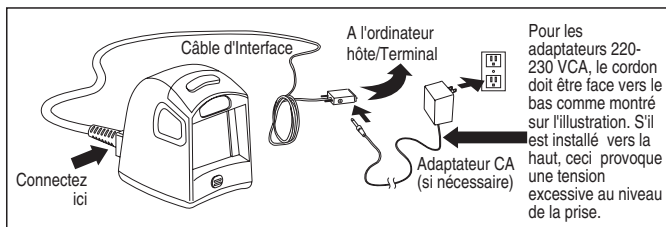

1. Le bip sonore et le clignotement de la diode LED peuvent être sélectionnés et peuvent avoir été désactivés par un utilisateur précédent.

Support Facultatif

Un support facultatif est disponible pour le scanner qui peut être fixé en permanence à un mur ou à un comptoir. Après avoir placé le support dans une position optimale, le scanner (ainsi que le support) peuvent être détachés pour un usage portatif en levant l'unité complète comme illustré ci-dessous.

Alimentation Électrique

Certains modèles exigent¹ une source d'alimentation avec courant de sortie de Classe 2 ou à puissance limitée (LPS) qui fournit l'électricité directement à l'unité.

Comment Scanner

La lecture peut être en mode mains libres pour les pièces faciles à manipuler ou à la main pour les pièces plus encombrantes.

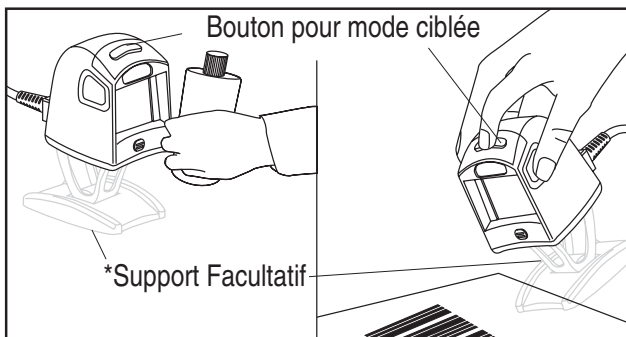

1. Les unités de mise hors tension du terminal n'exigent aucune alimentation électrique.

Mode Saisie Ciblée

Afin de saisir un code-barre (option commutation uniquement)...

- appuyez et maintenez la pression sur le bouton de commutation. Un rayon de visée apparaîtra.
- centrez bien le rayon de visée au-dessus des codes à barres qui doit être saisi, puis relâchez le bouton pour lire l'étiquette.



NOTE

Le scanner ne lira pas les codes à barres tant que le bouton sera enfoncé. Le Mode de Saisie Ciblée lira les codes à barres dans n'importe quel sens. Le scanner retournera complètement en mode Omni après qu'un certain temps configurable se sera écoulé.

Diagnostic de Pannes

Si le lecteur ne fonctionne pas correctement, effectuez les vérifications suivantes :

1. Si le lecteur utilise une alimentation électrique extérieure et que l'alimentation extérieure ne fonctionne pas, le lecteur ne fonctionnera pas. Echangez la source d'alimentation avec une autre alimentation électrique correcte et effectuez de nouveau l'opération pour vérification.

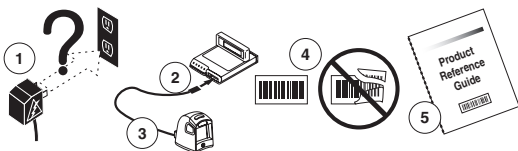

2. Vérifiez que le câble d'interface est correctement connecté à l'ordinateur hôte/terminal. Consultez votre service technique ou référez-vous au manuel de votre ordinateur hôte afin de vérifier si la connexion au lecteur est correcte.

3. Vérifiez que le câble d'interface est connecté correctement au lecteur.
4. Contrôlez que la qualité des codes à barres est suffisante pour que ceux-ci soient reconnus par le scanner. Les étiquettes pliées, sales ou déchirées peuvent empêcher le scanner de lire les codes. Saisissez des étiquettes correctes avec une symbologie¹ active afin de vérifier que le scanner effectue l'opération de saisie correctement.
5. Assurez-vous que le type d'interface du scanner est compatible avec le terminal hôte en consultant la manuel de votre système POS et/ou le Guide de Référence du Produit.

Si le lecteur ne fonctionne toujours pas correctement, contactez votre fournisseur local ou le Service d'Assistance Clientèle de PSC.

Déclaration de Conformité

Cet appareil est conforme aux Règles (PART 15 Rules) en matière d'émissions et d'interférences des services de la FCC. Son fonctionnement est soumis aux conditions suivantes :

1. Cet appareil ne doit pas provoquer d'interférences nuisibles; et
2. Cet appareil doit accepter toute interférence reçue, y compris les interférences qui peuvent provoquer des opérations non désirées.

This Class A digital apparatus complies with Canadian ICES -003.

Cet appareil numérique de la classe A est conforme à la norme NMB-003 du Canada.

LED Class

CLASS 1 LED PRODUCT	APPARECCHIO LED CLASSE 1
LED KLASSE 1	APPAREIL A LED DE CLASSE 1
PRODUIT LED CLASSE 1	EN60825-1

-
1. La lecture des différentes symbologies et de codes à barres peuvent être activées ou désactivées de façon indépendante.

Schnellanleitung

Diese Anleitung soll eine schnelle und effiziente Installation und Inbetriebnahme ermöglichen. Weitere Einzelheiten, u.a. zur Programmierung, entnehmen Sie dem Produktleitfaden (Product Reference Guide, PRG), der zum Anzeigen und Herunterladen auf der PSC-Webseite verfügbar ist (siehe Rückseite dieses Leitfadens).

Installation

Verlegen Sie das Interfacekabel vom Haupt- oder Endgerät. Schließen Sie den Netzadapter (sofern verwendet) an einer Netzsteckdose und am Interfacekabel (IF-Kabel) an, und verlegen Sie das IF-Kabel zum Scanner und schließen es daran an. Führen Sie einen Funktionstest aus, indem Sie mit dem Scanner garantiert funktionsfähige Barcodes einlesen. Das Gerät muss einen Piepton¹ aussenden und/oder mit der gut sichtbaren LED blinken und die Barcodedaten an das End- oder Hauptgerät senden. Andernfalls ziehen Sie den Abschnitt zu Fehlerbehebung in diesem Leitfaden zurate.

Die Scannerinstallation ist abgeschlossen.

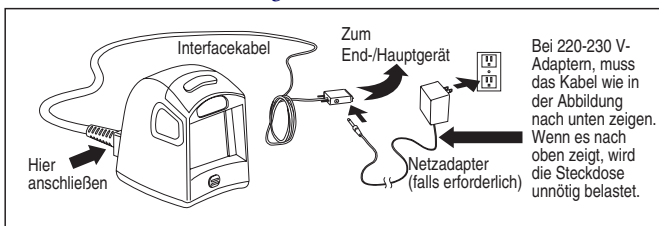

1. Piepton- und LED-Verhalten können eingestellt werden und sind durch Vornutzer ggf. deaktiviert.

Optionaler Ständer

Zu dem Scanner gibt es einen optionalen Sockel zur dauerhaften Befestigung an einer Wand oder Ladentheke. Nachdem Sie den Sockel optimal positioniert haben, können Sie den Scanner (mit Sockel) für freihändigen Einsatz abnehmen, indem Sie das gesamte Gerät wie unten dargestellt anheben.

Stromversorgung

Für einige Modelle ist eine Stromversorgung mit Klasse 2- oder LPS-Zulassung für direkte Stromversorgung erforderlich¹.

Scanverfahren

Barcodes werden mit dem Scanner eingescannt, während dieser auf der Ladentheke steht oder am optionalen Sockel befestigt ist, oder indem der Scanner/die Halterung hochgehoben und wie folgt gehalten wird.

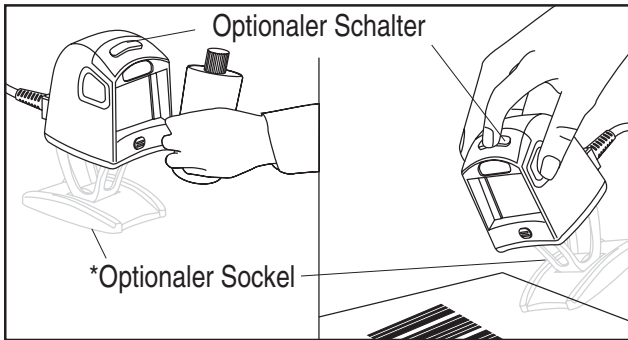

-
1. Für Geräte mit POT-Option (Power Off the Terminal) ist keine Stromversorgung erforderlich.

Zielscanmodus

So lesen Sie einen Barcode ein (nur optionaler Schalter):

- Schalter gedrückt halten Ein Zielmuster wird angezeigt.
- Zielmuster entsprechend über dem einzulesenden Barcode ausrichten und Schalter zum Scannen des Etiketts loslassen.



HINWEIS

Bei gedrücktem Schalter werden die Barcodes vom Scanner nicht eingelesen.

Mit dem Zielscanmodus werden Barcodes in jeder Ausrichtung eingelesen.

Der Scanner wechselt nach Ablauf einer konfigurierbaren Zeit wieder in den omnidirektionalen Vollmustermodus.

Fehlerbehebung

Bei fehlerhaftem Scannerbetrieb prüfen Sie Folgendes:

1. Wenn der Scanner mit einer externen Stromversorgung betrieben wird, funktioniert er nicht, wenn diese ausfällt. Stromversorgung durch ein garantiert funktionsfähiges Gerät ersetzen und Betrieb testen.

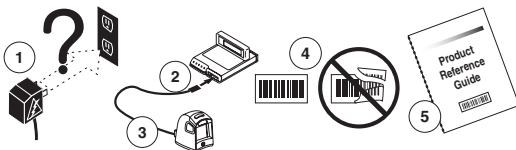

2. Sicherstellen, dass das Interfacekabel am Endgerät richtig angeschlossen ist. Wenden Sie sich an Ihr zuständiges Technikpersonal oder ziehen Sie das Endgeräthandbuch zurate, um einen ordnungsgemäßen Anschluss des Scanners sicherzustellen.

3. Sicherstellen, dass das Interfacekabel am Scanner richtig angeschlossen ist.
4. Sicherstellen, dass die Barcodes ausreichende Qualität aufweisen, um vom Scanner erkannt zu werden. Zerknitterte, beschmierte, oder angerissene Etiketten machen ein Einlesen unmöglich. Scannen Sie garantiert gute Etiketten mit aktiver Symbologie¹, um die Einlesefunktion des Scanners zu überprüfen.
5. Vergewissern Sie sich, dass der Schnittstellentyp des Scanners mit dem Endgerät kompatibel ist, indem Sie das Handbuch des POS-Systems und/oder den Produktleitfaden (Product Reference Guide) zurate ziehen.

Wenn der Scanner weiterhin nicht ordnungsgemäß funktioniert, wenden Sie sich an Ihren örtlichen Händler oder an den PSC-Kundensupport.

Erfüllung von Vorschriften

Dieses Gerät erfüllt Teil 15 der FCC-Bestimmungen. Der Betrieb unterliegt den folgenden Bedingungen:

1. Dieses Gerät darf keine schädlichen Störungen produzieren, und:
2. Dieses Gerät muss für den Empfang von Störungen, darunter Störungen, die unerwünschtes Betriebsverhalten auslösen, ausgelegt sein.

Dieses Digitalgerät der Klasse A entspricht dem kanadischen Standard ICES -003.

LED-Klasse

CLASS 1 LED PRODUCT	APPARECCHIO LED CLASSE 1
LED KLASSE 1	APPAREIL A LED DE CLASSE 1
KLASSE 1 LED-PRODUKT	EN60825-1

-
1. Das Einlesen der verschiedenen Barcodesymbolgien kann im Scanner unabhängig aktiviert bzw. deaktiviert werden.

Guida Rapida

La presente guida vi aiuterà ad eseguire un'installazione rapida ed efficace. Per ulteriori dettagli, inclusi i dettagli relativi alla programmazione, consultare la Guida di Riferimento del Prodotto, che può essere consultata online e scaricata dal sito di PSC indicato sul retro del presente manuale.

Installazione

Svolgere il cavo d'interfaccia dal terminale o host. Inserire l'eventuale adattatore CA nella presa a parete e nel cavo d'interfaccia (I/F), quindi collegare il cavo I/F allo scanner. Verificare il funzionamento facendo leggere allo scanner dei codici a barre dei quali si conosce il contenuto e in buono stato. L'unità emetterà un suono¹ e/o farà lampeggiare il LED che segnala la corretta lettura del codice e invierà i dati del codice all'host o al terminale. In caso contrario, consultare la sezione "Risoluzione dei problemi" della presente guida.

L'installazione dello scanner è completa.

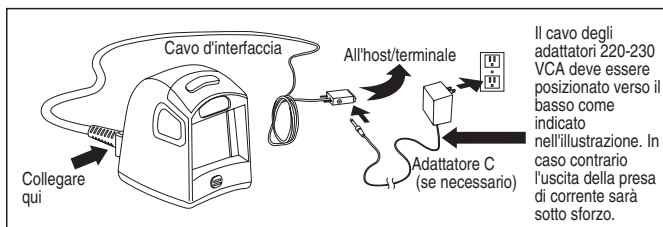

1. È possibile selezionare suono oppure LED. Tenere conto della configurazione impostata dall'utente che ha utilizzato lo scanner in precedenza.

Supporto Opzionale

È disponibile un supporto opzionale che può essere attaccato permanentemente alla parete o sul bancone. Dopo aver posizionato il supporto in posizione ottimale, lo scanner e il supporto potranno essere staccati per l'utilizzo mobile sollevando l'intera unità come illustrato in basso.

Alimentazione

Alcuni modelli necessitano¹ una sorgente di alimentazione Classe 2 o LPS che alimenti direttamente l'unità.

Come utilizzare lo Scanner

È possibile presentare i codici al lettore, mentre è posizionato sul bancone oppure inserito nel supporto opzionale, oppure lo scanner può essere sollevato come da illustrazione.



1. Le unità alimentate dal terminale (POT - Power Off the Terminal) non richiedono alimentazione di rete.

Modalità di Scansione a Bersaglio

Per utilizzare lo scanner con il pulsante opzione:

- tenere premuto il pulsante. Apparirà un mirino luminoso.
- Posizionare il mirino luminoso al centro del codice a barre da leggere e rilasciare il pulsante opzione per eseguire la lettura.



NOTE

Lo scanner non legge i codici, se il pulsante è premuto.

La modalità di scansione bersaglio consente di leggere codici orientati in qualunque verso.

Lo scanner ritornerà in modalità Omni dopo un periodo di tempo impostabile.

Risoluzione dei Problemi

Nel caso lo scanner non funzionasse correttamente, eseguire i seguenti controlli:

1. Se lo scanner utilizza un'alimentazione esterna e quest'ultima non fosse operativa, lo scanner non funzionerà. Utilizzare una sorgente di alimentazione affidabile e riprovare.

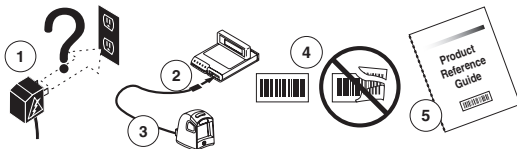

2. Verificare che il cavo d'interfaccia sia saldamente collegato all'host. Consultare il proprio personale tecnico oppure il manuale del sistema host per controllare il corretto collegamento dello scanner.

3. Verificare che il cavo d'interfaccia sia saldamente collegato allo scanner.
4. Controllare che i codici a barre siano di qualità sufficientemente leggibile per lo scanner. Etichette piegate, strappate o sbavate potrebbero non essere leggibili. Utilizzare etichette sicuramente leggibili che appartengono ad un sistema di simbologia¹ utilizzato per controllare il funzionamento dello scanner in lettura.
5. Assicurarsi che il tipo di interfaccia dello scanner sia compatibile con il terminale/host consultando il manuale del POS e/o la Guida di riferimento del prodotto.

Se lo scanner non funziona correttamente, contattare il rivenditore locale oppure il Servizio Assistenza Clienti di PSC.

Dichiarazione di Conformità

Il presente dispositivo è conforme ai regolamenti Part 15. Il funzionamento è soggetto alle seguenti condizioni:

1. il dispositivo non deve causare interferenze dannose; e
2. il dispositivo deve accettare qualsiasi interferenza ricevuta, incluso le interferenze che potrebbero causare un funzionamento non desiderato.

Il presente apparato digitale di Classe A è conforme alla normativa canadese ICES-003.

Classe LED

CLASS 1 LED PRODUCT	APPARECCHIO LED CLASSE 1
LED KLASSE 1	APPAREIL A LED DE CLASSE 1
PRODOTTO LED CLASSE 1	EN60825-1

1. La lettura delle varie simbologie dei codici a barre può essere indipendentemente abilitata o disabilitata nello scanner.

Guía de Referencia Rápida

La finalidad de esta guía es ayudarle a instalar el equipo de forma rápida y eficiente. Para obtener más datos, incluida información de programación, consulte la Guía de referencia del producto (PRG) que podrá ver y descargar de la página Web de PSC, cuya dirección aparece en la contracubierta de este manual.

Instalación

Encamine el cable de interfaz desde el terminal o el equipo central. Conecte el adaptador de CA (si se utiliza uno) a una toma de corriente de pared y al cable de interfaz (I/F). A continuación encamine y conecte el cable I/F al escáner. Para comprobar el funcionamiento, coloque un código de barras en buen estado ante el escáner. La unidad emitirá un pitido¹ y/o parpadeará el LED de lectura correcta y enviará los datos del código de barras al equipo central o al terminal. Si no es así, consulte la sección Solución de averías de esta guía.

La instalación del escáner ha finalizado.

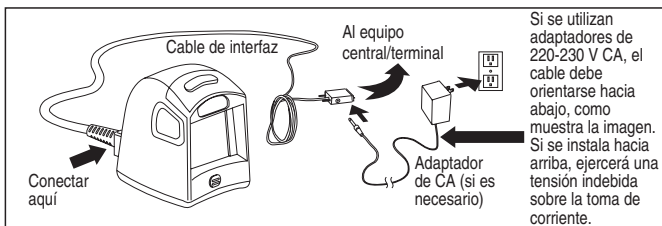

1. El funcionamiento del indicador acústico y el LED es seleccionable y es posible que un usuario anterior lo haya desactivado.

Soporte Opcional

Existe un soporte opcional para el escáner que puede acoplarse de forma permanente a una pared o a un mostrador. Después de colocar el soporte en la posición óptima, se podrá desmontar el escáner (junto con el soporte) si desea trasladarlo de lugar. Para ello, solo tiene que elevar la unidad completa, tal y como muestra la imagen.

Suministro Eléctrico

Algunos modelos precisan¹ una fuente de alimentación de Clase 2 o LPS homologada que suministre electricidad directamente a la unidad.

Instrucciones Para Escanear

Los códigos de barras pueden colocarse delante del escáner mientras éste permanece apoyado sobre el mostrador o el soporte opcional. También es posible elevar y sostener el escáner/unidad como muestra la imagen.

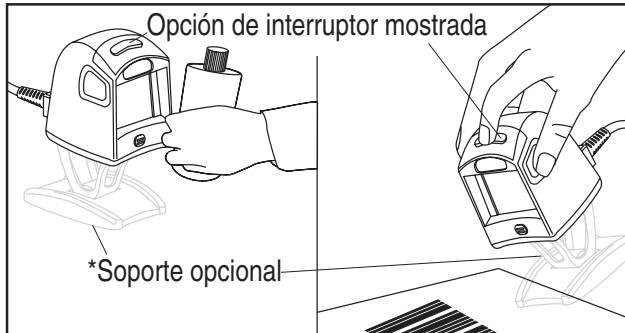

1. Las unidades de desconexión del terminal (POT) no precisan una fuente de alimentación.

Modo de Exploración de Objetivo

Para leer un código de barras (solo opción de interruptor)...

- Mantenga pulsado el interruptor. Aparecerá un haz para apuntar.
- Centre el haz para apuntar lo más posible sobre el código de barras que vaya a leer y suelte el interruptor para leer la etiqueta.



NOTA

El escáner no leerá códigos de barras mientras el interruptor permanezca pulsado.

El modo de exploración de objetivo leerá los códigos de barras en cualquier dirección.

El escáner volverá al modo de haz completo una vez que haya transcurrido un tiempo configurable.

Solución de Problemas

Si el escáner no funciona correctamente, deberán realizarse las siguientes comprobaciones:

1. Si el escáner utiliza una fuente de alimentación externa y dicha fuente se ha averiado, el escáner no funcionará. Cambie la fuente de alimentación por otra en buen estado y restablezca el funcionamiento.

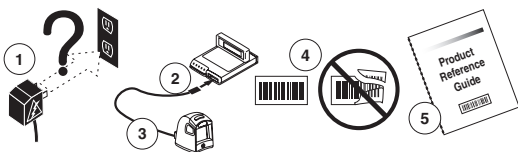

2. Compruebe que el cable de interfaz está perfectamente acoplado al equipo central. Pida ayuda al personal de asistencia técnica o consulte el manual del sistema central para comprobar que el escáner esta correctamente conectado.

3. Compruebe que el cable de la interfaz está perfectamente acoplado al escáner.
4. Compruebe que los códigos de barras tienen la calidad suficiente para ser reconocidos por el escáner. El escáner no leerá etiquetas arrugadas, emborronadas o rasgadas. Para comprobar el funcionamiento de la función de lectura del escáner, explore etiquetas que contengan una simbología activa en buen estado¹.
5. Asegúrese de que el tipo de interfaz del escáner es compatible con el terminal central. Para ello, consulte el manual del sistema POS y/o la Guía de referencia del producto.

Si el escáner sigue sin funcionar correctamente, póngase en contacto con su proveedor local o con el Departamento de Atención al Cliente de PSC.

Nota de Conformidad

Este dispositivo cumple las normas recogidas en la Sección 15. El funcionamiento está sujeto a las condiciones siguientes:

1. Este dispositivo no causará interferencia peligrosa, y
2. Este dispositivo aceptará cualquier interferencia recibida, incluida aquella que pueda causar un funcionamiento no deseado.

Este aparato digital de Clase A cumple la normativa canadiense ICES -003.

Clase de LED

CLASS 1 LED PRODUCT	APPARECCHIO LED CLASSE 1
LED KLASSE 1	APPAREIL A LED DE CLASSE 1
PRODUCTO LED de CLASE 1	EN60825-1

1. La lectura de distintas simbologías de códigos de barras puede activarse o desactivarse de forma independiente en el escáner.

Referência Rápida

Este guia é fornecido para ajudar a ter sua instalação funcionando rápida e eficientemente. Para obter maiores detalhes, incluindo informações de programação, consultar o Guia de Referência do Produto (PRG), que está disponível para visualização e download a partir do web-site PSC listado na contracapa deste manual.

Instalação

Rotear o cabo de interface a partir do terminal ou do host. Ligar o adaptador C.A. (se for usado um) em uma tomada na parede e o cabo de interface (I/F), então rotear e conectar o cabo I/F ao leitor. Verificar a operação apresentando códigos de barra em bom estado e reconhecidos pelo leitor. A unidade deve emitir um bip¹ e/ou lampear sua boa leitura, enviando os dados de código de barras para o host ou terminal. Caso contrário, consultar a seção Diagnóstico deste guia.

A instalação do leitor está completa.

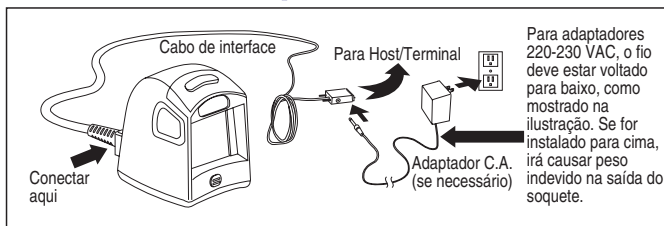

1. O comportamento do bip e do LED pode ser selecionado e pode estar desabilitado por um usuário anterior.

Suporte Opcional

Um suporte opcional está disponível para o leitor, que pode ser conectado permanentemente a uma parede ou um balcão. Após localizar o balcão em uma boa posição, o leitor (paralelo ao balcão) pode ser destacado para uso portátil, levantando a unidade como mostrado abaixo.

Fornecimento de Energia

Alguns modelos exigem¹ uma fonte de energia Listada Classe 2 ou Listada LPS, que fornece a energia diretamente para a unidade.

Como Fazer Leitura

Os códigos de barra podem ser apresentados ao leitor enquanto este está no balcão ou na suporte opcional, ou o leitor/montagem pode ser levantado e segurado como mostrado abaixo.



1. Fornecimento de energia das unidades do tipo POT não exigem uma fonte de energia externa.

Modo de Leitura Direcionada

Para ler um código de barra (somente opção de botão)...

- Pressionar e segurar o botão. Um padrão almejado irá aparecer.
- Com o padrão almejado centrado no código de barra para ser lido, soltar o botão para ler a etiqueta.



NOTA

O leitor não irá ler códigos de barra enquanto o botão estiver pressionado.

Modo de Leitura Etiquetado irá ler códigos de barra em qualquer orientação.

O leitor irá retornar para o padrão total Omni Mode depois que um tempo configurável tiver passado.

Diagnóstico

Se o leitor não estiver operando de forma apropriada, as seguintes verificações devem ser realizadas:

1. Se o leitor usar um fornecimento de energia externo e este estiver falhando, o leitor não irá operar. Trocar o fornecedor de energia com um reconhecidamente bom e testar novamente a operação.

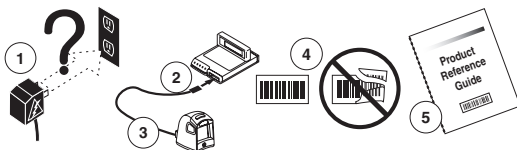

2. Verificar se o cabo de interface está conectado com segurança ao host. Consultar seu suporte técnico ou o manual do sistema host para verificar a conexão apropriada para o leitor.

3. Verificar se o cabo de interface está conectado de forma segura ao leitor.
4. Verificar se os códigos de barra são de qualidade suficiente para serem reconhecidos pelo leitor. Etiquetas dobradas, manchadas ou molhadas podem fazer com que o leitor não as leia. Fazer o scan de etiquetas boas de uma simbologia¹ para verificar a operação de leitura do leitor.
5. Garantir que o tipo de interface do leitor é compatível com o terminal host, consultando seu manual do sistema PDV e/ou o Guia de Referência do Produto.

Se o leitor não funcionar ainda adequadamente, contactar seu fornecedor local ou os Serviços de Suporte ao Cliente.

Declaração de Conformidade

Este dispositivo atende às regras Parte 15. A operação é submetida às seguintes condições:

1. Este dispositivo não pode causar interferências nocivas; e
2. Este dispositivo deve aceitar qualquer interferência recebida, incluindo interferência que pode causar operação indesejada.

Este equipamento digital Classe A atende à norma Canadense ICES -003.

Classe LED

CLASS 1 LED PRODUCT	APPARECCHIO LED CLASSE 1
LED KLASSE 1	APPAREIL A LED DE CLASSE 1
PRODUTO LED CLASSE 1	EN60825-1

1. A leitura de várias simbologias de código de barra pode ser independentemente habilitada ou desabilitada no leitor.

快速参考

提供本指南帮助您迅速有效地安装和运行。欲知详情，包括编程信息，请参阅产品参考指南 (PRG)，可以从本指南封底列出的PSC网站浏览和下载该指南。

安装

从终端或主机来的接口电缆进行布线。将AC适配器 (如果使用了的话) 插入墙壁上的电源插座和 (I/F) 电缆接口，然后布线并将 I/F 电缆连接到扫描器。用已知的好条形码进行检查。扫描器的喇叭

¹应该鸣响并且/或者它的LED应该闪烁以表示读数正确，同时将条码数据发送到主机或者终端。如果无鸣响或者不闪烁，参阅本指南的故障检修部分。

至此，扫描器安装完毕。

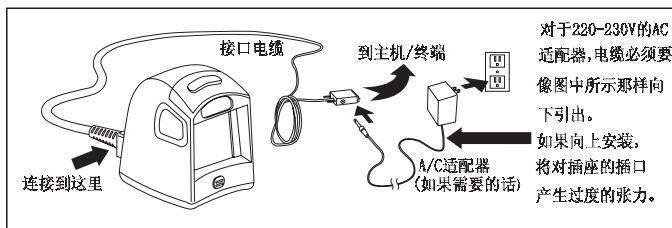

¹蜂鸣器和LED的状态可选，并可由先前用户禁止。

可選用機座

可使用可選機座將掃描器永久地裝在牆壁或櫃台上。將機座放在一個最佳位置後，可以像圖例所示的那樣舉起整個掃描器(與機座一起)進行使用。

電源

有些型號要求使用所列出的第 2 類或者 LPS 電源³對掃描器進行直接供電。

怎樣進行掃描

將條碼靜止在櫃台上或者可選機座上對着掃描器，或者將掃描器/機座如圖所示那樣舉起後進行掃描。

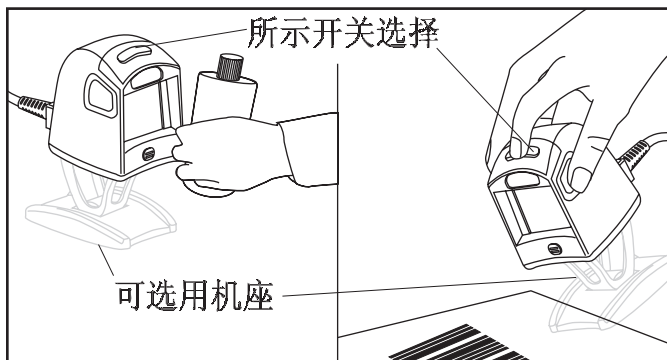

³ POT型不需要電源。

瞄准扫描模式

为了读条码（仅适用于开关型），应该：

- 压下开关并保持，进入瞄准模式。
- 在瞄准模式下对准要读取的条码，松开开关读标签。
-



注意

在开关被按着时扫描器不会读条码。

瞄准扫描模式能在任意方向上读条码。

在一定时间之后扫描器将返回到全向模式。

故障处理

如果扫描器不能正常工作，应当进行以下检查：

1. 如果扫描器使用外部电源供电而外部电源发生故障，则扫描器不会工作。用已知的能正常工作的电源进行替换并重新进行试验。
2. 检验接口电缆与主机是否牢固地连接。咨询技术支持人员或参阅主机系统指南以核实扫描器是否已经适当的连接。

3. 核查接口电缆是否牢固地与扫描器相连接。
4. 检查条码质量是否完好以便能让扫描器识别。起皱纹的、弄脏的、或者撕坏的标签可能导致扫描器根本无法读出。扫描已知完好的标签来检查扫描器的读操作。
5. 查阅POS系统手册和/或者产品参考指南确保扫描器的接口类型与主机终端兼容。

如果扫描器仍然不能正常工作,可与本地供应商或者PSC用户支持服务中心联系。

符合法规声明

本设备符合第15章有关规定。其操作符合以下条件:

1. 本设备不会引起有害的干扰;同时
2. 本设备必须接受任何所接收的干涉,包括可能引发错误操作的干涉。

A类数字式设备符合加拿大 ICES-003。

LED类

第1类 LED产品

クイック・リファレンス

このガイドでは、迅速かつ効率的にインストール手順を実行するための情報を提供します。プログラミング情報を含む詳細については、製品リファレンス・ガイド (PRG) を参照してください。PRG は、このマニュアルの背表紙に記載されている PSC Web サイトからダウンロードすることができます。

インストール

インターフェース・ケーブルをターミナルまたはホストに接続します。必要に応じて AC アダプタを壁コンセントおよびインターフェース (I/F) ケーブルに接続し、I/F ケーブルをスキャナに接続します。状態のよいバーコードをスキャンし、正しく作動するか確認してください。ユニットはピープ音¹を発するか、読み取り正常 LED を点滅させ、ホストまたはターミナルにバーコード・データを送信します。正しく作動しない場合は、このガイドのトラブルシューティング・セクションを参照してください。

これで、スキャナのインストールが完了しました。

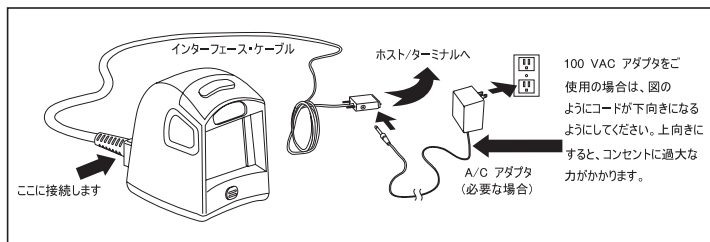

¹ ビーパーおよび LED の動作は選択可能です。また、以前のユーザーにより無効にされている場合があります。

オプションのスタンド

オプションのスタンドを使用すると、壁面または台上にスキャナを固定することができます。スタンドを最適な位置に配置した後も、図のようにユニット全体を持ち上げることにより、スタンドを取り付けたままスキャナを手持ちで使用することができます。

電源

一部のモデルは²、ユニットに直接電源を必要とします。

スキャンの仕方

スキャナを卓上またはオプションのスタンドに置いた状態、またはスタンドを取り付けたスキャナを図のように持ち上げた状態で、バーコードをスキャンすることができます。



² POT (Power Off the Terminal) ユニットには電源は不要です。

目標スキャンング・モード

バーコードを読み取るには（スイッチ・オプション使用の場合のみ）…

- スイッチを押したままにします。照準パターンが表示されません。
- 照準パターンを読み取るバーコードの中央に当て、スイッチを放してラベルを読み取ります。



注記

スイッチを押したままの状態では、スキャナはバーコードを読み取りません。目標スキャンング・モードでは、任意の向きのバーコードを読み取ることができます。設定時間を過ぎると、スキャナはフル・パターン・オムニ・モードに戻ります。

トラブルシューティング

スキャナが正しく作動しない場合は、以下の確認作業を行ってください。

1. 外部電源をお使いの場合は、外部電源が故障するとスキャナも作動しません。信頼できる電源装置と交換し、スキャナが作動するか再テストしてください。
2. インターフェース・ケーブルがホストにしっかりと接続されていることを確認してください。スキャナの正しい接続方法については、テクニカルサポートの担当者にお問い合わせいただくか、ホストのシステムマニュアルを参照してください。

3. インターフェース・ケーブルがスキャナにしっかりと接続されていることを確認してください。
4. バーコードの状態がスキャナで認識するのに十分な状態であることを確認してください。ラベルにしわ、汚れ、破れなどがあると、スキャナでまったく読み取れない場合があります。有効なシンボル体系³が印刷された状態のよいラベルをスキャンして、スキャナの読み取り機能をテストしてください。
5. スキャナのインターフェースのタイプとホストターミナルとの互換性を確認してください。確認方法は、POS システムマニュアルまたはスキャナの製品ガイドを参照してください。

上記の方法を実行してもスキャナが正しく作動しない場合は、お近くのサプライヤーまたはPSCカスタマーサポートサービスまでご連絡ください。

³ さまざまなバーコード体系ごとに、スキャナでの読み取りを有効または無効にすることができます。

適合性について

本製品は、VCCIに適合しています。操作は以下の条件に従います。

1. この装置は有害な干渉を起こさない。
2. この装置は、誤作動を起こす可能性がある干渉を含め、受信したあらゆる干渉を受け入れなければならない。

本製品は、VCCIに適合したクラスB デジタル装置です。

LED クラス

クラス 1 LED 製品

NOTES

NOTES



PSC Inc. hereby declares that the equipment specified below has been tested and found compliant to the following directives and standards.

EU Directives

89/336/EEC EMC
73/23/EEC Low Voltage
2002/96/EC WEEE

Standards

EMC: FCC part 15B Class B:2003 (US)
ICES-003 Class B:1997 (Canada)
VCCI Class B:2001 (Japan)
EN 55022 Class B:1998 (EU)
CNS 13438 Class B:1997 (Taiwan)
AS/NZS 3548 Class B:1998
GOST EMC approved (Russia)
CISPR 22 Class B:1992/1997 (World)

Product Safety: UL 60950-1:2003 (US)
CSA 60950:2003 (Canada)
EN 60950:2001 (Europe)
EN 60825-1/A2:2001 (EU)
IEC 60950-1:2001 (World)
IEC 60825-1:2001 (World)
NOM:1994 (Mexico)

Immunity: EN55024:2001 - ITE (EU)
EN 61000-3-2:2000 - Harmonic Current (EU)
EN 61000-3-3:1995 - Voltage Flicker (EU)

Quality Systems: ISO 9001:2000
BS EN ISO 9001:2000

Power Supply (optional):UL 60950 (US)
CSA 60950 (Canada)
EN 60950/IEC 60950 (World)

Most World Standards

Equipment Type: Barcode Scanning

Product Model Name: Magellan® 1000i

Serial Number Start Sequence: Cxxxxxxx

Date Placed into EU Service: December 2005

Responsible Manufacturer: PSC Inc./PSC Scanning, Inc.
959 Terry St. Eugene, OR 97402 US



IE 01

Asia Pacific

PSC Hong Kong
Hong Kong
Telephone: [852]-2-584-6210
Fax: [852]-2-521-0291

Italy

PSC S.p.A.
Vimercate (MI), Italy
Telephone: [39] (0) 39/62903.1
Fax: [39] (0) 39/6859496

Australia

PSC Asia Pacific Pty Ltd.
North Ryde, Australia
Telephone: [61] 0 (2) 9878 8999
Fax: [61] 0 (2) 9878 8688

Japan

PSC Japan K.K.
Shinagawa-ku, Tokyo, Japan
Telephone: 81 (0)3 3491 6761
Fax: 81 (0)3 3491 6656

France

PSC S.A.R.L.
LES ULIS Cedex, France
Telephone: [33].01.64.86.71.00
Fax: [33].01.64 46.72.44

Latin America

PSC S.A., INC.
Miami, Florida, USA
Telephone: (305) 591-3222
Fax: (305) 591-3007

Germany

PSC GmbH
Darmstadt, Germany
Telephone: 49 (0) 61 51/93 58-0
Fax: 49 (0) 61 51/93 58 58

United Kingdom

PSC Bar Code Ltd.
Watford, England
Telephone: 44 (0) 1923 809500
Fax: 44 (0) 1923 809 505



www.psc.com

PSC Inc.

959 Terry Street
Eugene, OR 97402
Telephone: (541) 683-5700

